

# BACK CHAMFERING UNIT

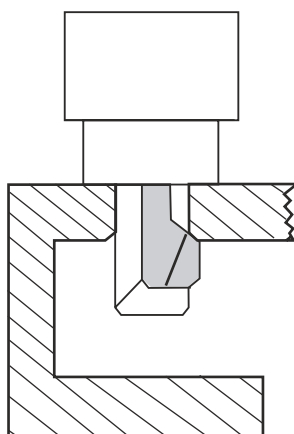

1. Cutter (Produces chamfer to desired angle)
2. Location Pilot (Ground to suit component bore)
3. Bearing Nose Piece (Prevents face damage)
4. BCU Operating Head Bearing Nose Piece (Prevents face damage)
5. Adjustable Collar (Sets chamfer distance from nose piece 'L')
6. Limiting Nut (Set diameter for cutting chamfer)



FLAT OR RESTRICTED FACES

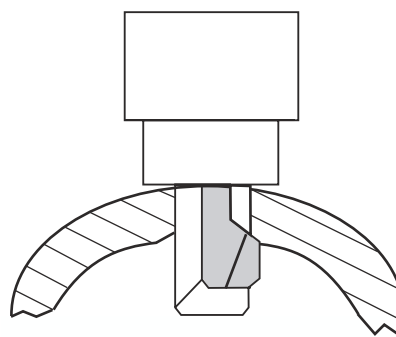

CURVED SURFACES

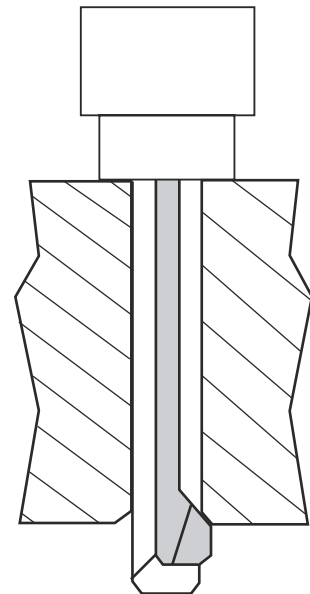

LONG REACH APPLICATIONS